

RE100-Pro LCD Digital Rotary Evaporator



Patented condenser with cooling surface 1,500 cm²

Motor lift

Chemical-resistant double PTFE system and patented pressure spring provide excellent sealing

- Large digital LCD screen displays heating temperature, rotation speed and timing.
- Integrated operating panel is located below the bath and thus outside the hazardous area.

5L water-oil heating bath
Heating temperature range:
Room temp.-180°C

Features:

- Large digital LCD screen displays heating temperature, rotation speed and time.
- Motor lift configurations, automatic release of the evaporating flask to top position in case of power failure.
- Wide temperature range of the 5L heating bath (Room temp. -180 °C) covers the widest applicational needs and has a safety temperature cut off 220°C.
- Speed range from 20 to 280 rpm, and interval operation in clockwise and counterclockwise directions for drying process.
- Patented condenser (cooling surface 1,500 cm²) with excellent cooling effect
- Experience the advantage of the automatic process timer which turns off your evaporator at a pre-programmed time and removes the evaporating flask from the bath
- Easy evaporating flask removal thanks to the ejector
- Chemical-resistant double PTFE system and patented pressure spring provide excellent sealing
- PC can control and document all parameters via USB interface



Specifications

Voltage [VAC]	100-120/200-240
Frequency [Hz]	50/60
Power [W]	1400
Motor Principle	Brushless DC motor
Speed Range [rpm]	20-280
Speed Display	LCD
Reversible Direction of Rotation	Yes
Heating Temperature Range [°C]	Room temp.-180
Heat Control Accuracy [°C]	±1
Heat Output [W]	1300
Temperature Display	LCD
Lift	Motor
Stroke [mm]	150
Timer	Yes
Timer Display	LCD
Time Setting Range [min]	1-999
Overall Dimensions [D×W×H mm]	465×457×583
Weight [kg]	15
Permissible Ambient Temperature [°C]	5-40
Permissible Relative Humidity	80%
Protection Class acc. To DIN EN60529	IP20
USB Interface	Yes



Accessories

condenser

Condenser type: vertical
Cooling surface: 1500 cm²
Cat. No: 18900165

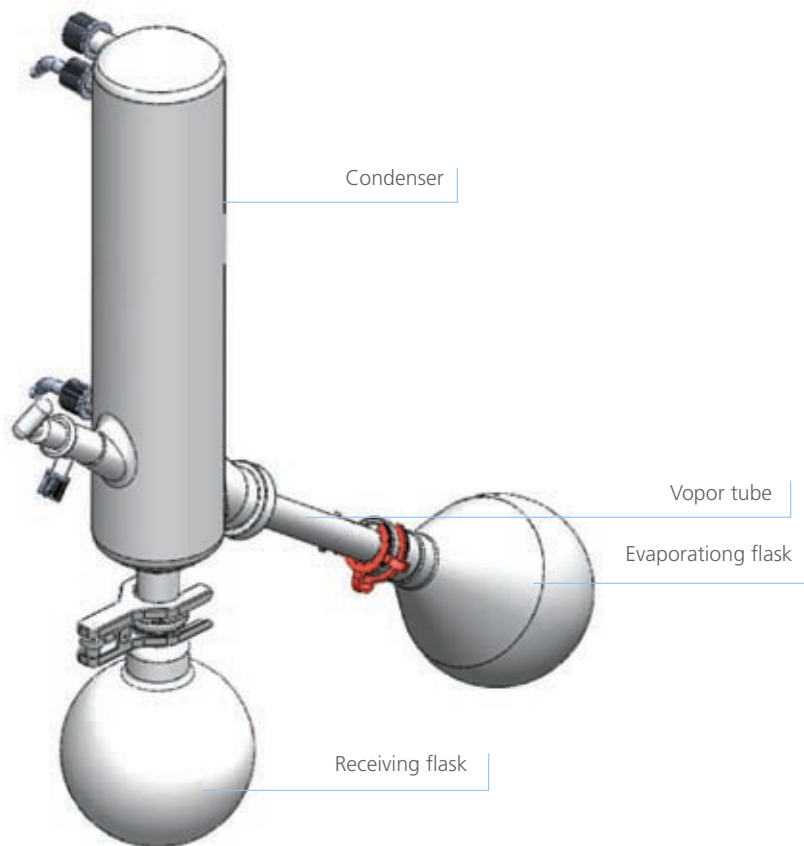

Evaporating flask
NS 29/32



Receiving flask
KS 35/20

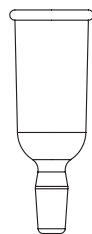

Connector
NS 29/32



Cat. No.	Volume
18300116	50mL
18300117	100mL
18300118	250mL
18300119	500mL
18300120	1000mL
18300121	2000mL
18300122	3000mL

Cat. No.	Volume
18300107	100mL
18300108	250mL
18300109	500mL
18300110	1000mL
18300111	2000mL

Cat. No.	Size
18300094	29/24
18300095	29/19
18300096	29/14

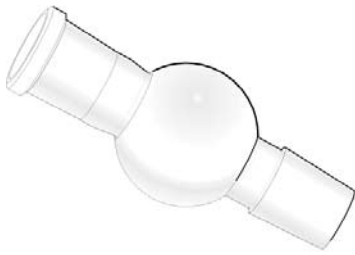

Foam brake, 250mL

NS 29/32
Cat. No: 18300093

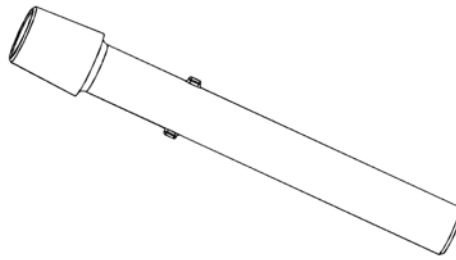

Vapor tube

NS 29/32
Cat. No: 18300097



Seal

Cat. No: 18300098

Vacuum pump
Cat. No: 18200743



Voltage [V]		110,220
Frequency [Hz]		50/60
Power [W]		95
Maximum Vacuum [mbar]		13
Pump Speed	0 mmHg	25 L/min
	100 mmHg	22 L/min
	200 mmHg	20 L/min
	300 mmHg	12 L/min
	400 mmHg	7.5 L/min
	550 mmHg	5 L/min
Suction Nozzle Size [mm]		8
Motor speed [rpm]		1450
Weight [kg]		7
Noise [dB]		50

Recirculating chiller
Cat. No: 18200746



Model		F250
Temperature range [°C]		-10~+40
Temperature stability [°C]		±0.5
Temperature display		LED
Pump capacity flow rate [L/min]		15
Pump capacity flow pressure [bar]		0.35
Cooling capacity	20 °C	0.25KW
	10 °C	0.22 KW
	5 °C	0.21KW
	0 °C	0.18 KW
	-5 °C	0.09 KW
Filling volume [L]		1.7 ~ 2.6
Weight [kg]		27
Dimensions [WxLxH, cm]		24x40x52